

HD-SMD Outdoor Series

High definition outdoor solution



The new outdoor visual standard

Pixel pitch 8mm outdoor
Viewing distance 6m-100m
High definition 15625pixel per square meter
Outdoor SMD technology
Complete IP65 outdoor solution
Optimum outdoor quality and cost ratio solution

Super LED Modules:

Key benefits

- ✧ black base&cover
- ✧ Advanced mechanical design
- ✧ Constant currency driving
- ✧ Quick dust cleaning
- ✧ Absolute RGB color blending
- ✧ Pure Color between each pixels
- ✧ Wide viewing angle 120/120
- ✧ Even color temperatures
- ✧ High brightness up 6500nits

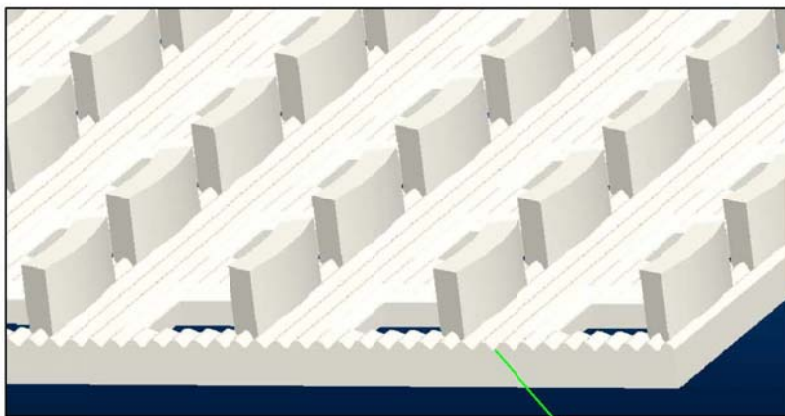

Mechanical groove design
reduce the reflecting effectively

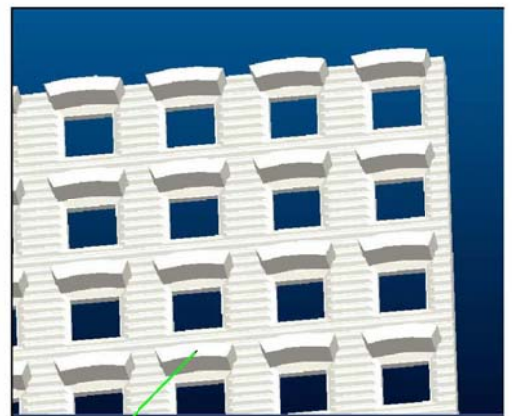

Mechanical cover design
Reduce the direct sunlight
Prolong the lifetime of the display

Normal oval led outdoor display

VS

HD-SMD outdoor display

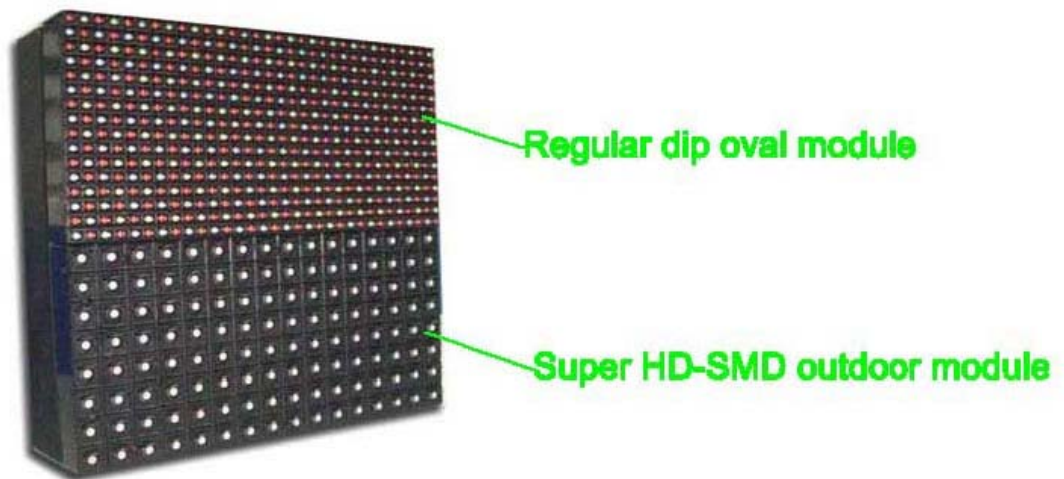

Comparisons:

HD-SMD outdoor display has better color blending, contrast ratio, flatter surface, quicker and easier cleaning, and much better white balance performance at same viewing distance.

Panels in different application:

1. Structure prepared installation

(Without-door simple panel)



2. Fast fixed installation

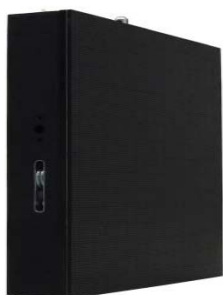

3. Rental installation



	Spec
Pitch	PH8mm
LED Lamp Model Type	SMD 3in1
Brightness (6500Kelvin)	6500 Nits
Panel Size	960×768
Panel Resolution	120×96
IP Rating	IP65/IP54
Panel Net Weight(Steel)	≤40kg
Pixel Density (/sqm)	15625
Horizontal Viewing Angle (dgr.)	120
Vertical Viewing Angle (dgr.)	120
Best Viewing Distance	8m
Recommend Min Screen Size	3 m ²
Input Voltage	AC110V/220, 60/50Hz
Power Consumption -Max (/Sqm)	0.95 kw
Power Consumption -Ave. (/Sqm)	0.5 kw
Driving Mode	1/4 Scan rate
Communication Profile	RS232/WIFI/Network
Gray Scale	16384
Brightness Level	16 Ranks
Refresh Frequency	200-1200Hz Adjustable
Pixels Lost Control	<300ppm
Colors	4.4 Trillion Colors
Operate Temperature	-20℃～70℃
Operate Humidity	10%～95%RH

Photo Gallery: